

As of February 5, 2010

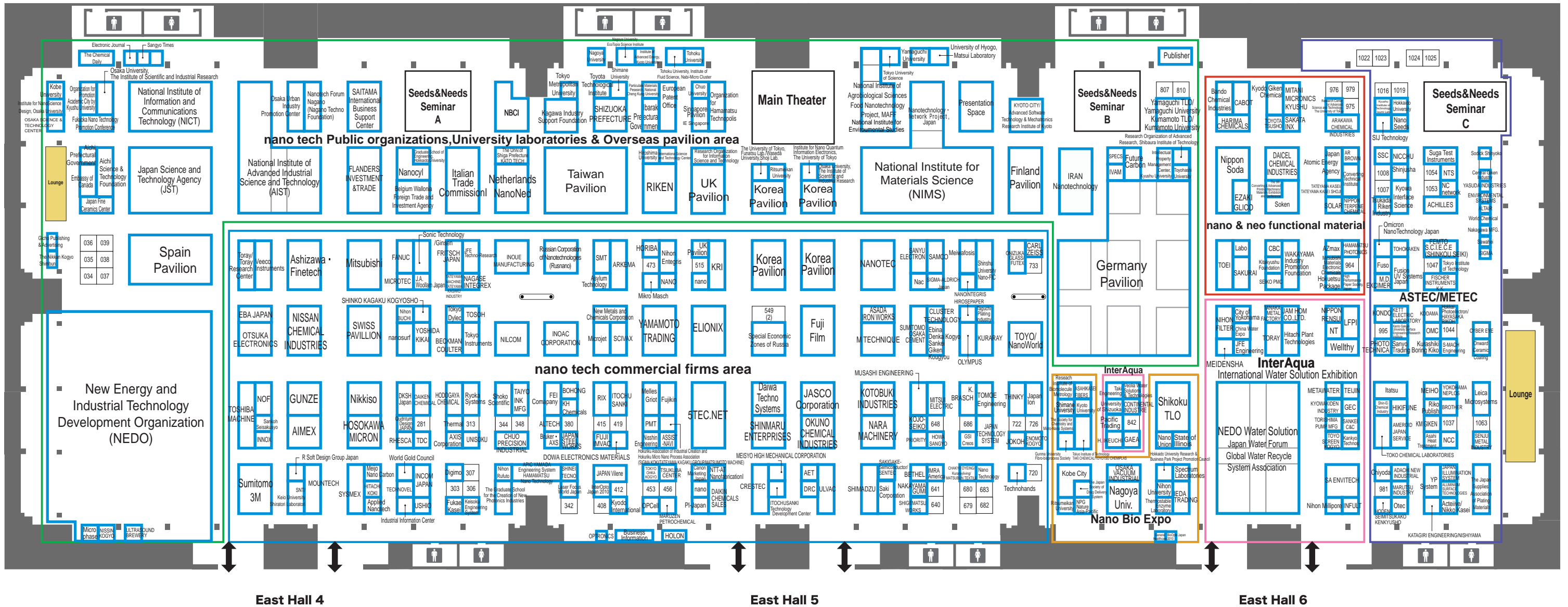

■ Date : Feb. 17(Wed.)-19(Fri.), 2010  
 ■ Venue : Tokyo Big Sight  
 ■ Venue : East Exhibition Hall 4,5,6  
  
 Exhibition Fee/per booth (3m x 3m = 9m.)  
  
 Commercial firms : 336,000JPY/1booth  
 Public organizations & Overseas pavilion : 168,000JPY/1booth  
 \* tax included.